

# Go! Go! Cory Carson<sup>®</sup> Fire Rescue Freddie™

## Unlock the Packaging Locks

- 1 Rotate the packaging lock counterclockwise several times.
- 2 Pull out the packaging lock and discard.

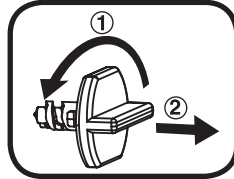

## Battery Removal and Installation

1. Make sure the unit is turned **OFF**.
2. Find the battery cover located on the bottom of the unit, use a screwdriver to loosen the screw and then open the battery cover.
3. Remove old batteries by pulling up on one end of each battery.
4. Install 2 new AAA (AM-4/LR03) batteries following the diagram inside the battery box. (For best performance, alkaline batteries or fully charged Ni-MH rechargeable batteries are recommended).
5. Replace the battery cover and tighten the screw to secure.

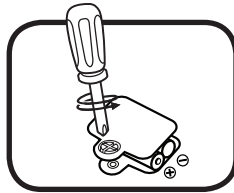

**WARNING:** All packing materials such as tape, plastic sheets, packaging locks, removable tags, cable ties, cords and packaging screws are not part of this toy, and should be discarded for your child's safety.

**NOTE:** Please keep this parents' guide as it contains important information.

**ATTENTION :** Pour la sécurité de votre enfant, débarrassez-vous de tous les produits d'emballage tels que rubans adhésifs, feuilles de plastique, attaches, étiquettes, cordons et vis d'emballage. Ils ne font pas partie du jouet.

**NOTE :** Il est conseillé de conserver ce guide des parents car il comporte des informations importantes.

## ⚠ WARNING:

Adult assembly required for battery installation.  
Keep batteries out of reach of children.

## ⚠ ATTENTION :

Les piles ou accumulateurs doivent être installés par un adulte.  
Tenir les piles ou accumulateurs hors de portée des enfants.

## IMPORTANT: BATTERY INFORMATION

- Insert batteries with the correct polarity (+ and -).
- Do not mix old and new batteries.
- Do not mix alkaline, standard (carbon-zinc) or rechargeable batteries.
- Only batteries of the same or equivalent type as recommended are to be used.
- Do not short-circuit the supply terminals.
- Remove batteries during long periods of non-use.
- Remove exhausted batteries from the toy.
- Dispose of batteries safely. Do not dispose of batteries in fire.

## RECHARGEABLE BATTERIES

- Remove rechargeable batteries from the toy before charging.
- Rechargeable batteries are only to be charged under adult supervision.
- Do not charge non-rechargeable batteries.

## PRODUCT FEATURES

### 1. On/Off Switch

To turn the unit **On**, slide the **On/Off Switch** to the **On** ⏻ position. To turn the unit **Off**, slide the **On/Off Switch** to the **Off** ● position.

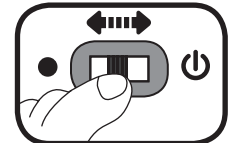

### 2. Automatic Shut-Off

To preserve battery life, the **Go! Go! Cory Carson<sup>®</sup>** character will automatically power down after approximately 30 seconds without input. The unit can be turned on again by pressing the **Light-Up Button**, placing or removing the accessory on the character or by rolling the character quickly.

**NOTE :** This product is in a Try-Me mode in the packaging. After opening the packaging, turn the character **Off** and **On** again, or before the product goes into sleep mode, put the accessory on top of the character for more than 2 seconds to proceed with normal play. If the unit powers down while playing, we suggest changing the batteries.

**NOTE :** Ce produit est actuellement en mode démonstration. Une fois déballé, veuillez éteindre puis remettre en marche ce jouet ou veuillez placer l'accessoire sur le personnage pendant plus de 2 secondes avant qu'il ne se mette en veille pour activer toutes ses fonctionnalités. Si le personnage s'éteint pendant le jeu, veuillez insérer des piles neuves.

## ACTIVITIES

### 1. Light-Up Button

Press the **Light-Up Button** to hear sounds, songs, phrases and melodies. The light will flash with the sounds.

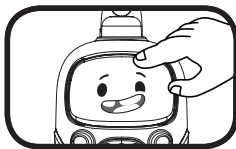

### 2. Stacking Fun

Place the accessory on the character's back to unlock new phrases and fun content. The lights will flash with the sounds.

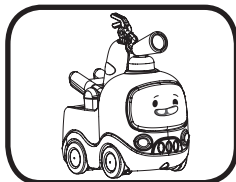

### 3. Sounds and Melodies

Push to hear fun sounds. If a melody is already playing, push the character to add fun sounds on top of the melody. The light will flash with the sounds.

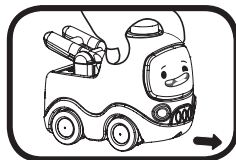

## CARE & MAINTENANCE

1. Keep the unit clean by wiping it with a slightly damp cloth.
2. Keep the unit out of direct sunlight and away from any direct heat sources.
3. Remove the batteries if the unit will not be in use for an extended period of time.
4. Do not drop the unit on hard surfaces and do not expose the unit to moisture or water.

## TROUBLESHOOTING

If for some reason the unit stops working or malfunctions, please follow these steps:

1. Turn the unit **Off**.
2. Interrupt the power supply by removing the batteries.
3. Let the unit stand for a few minutes, then replace the batteries.
4. Turn the unit **On**. The unit should now be ready to play again.
5. If the product still does not work, install a new set of batteries.

### IMPORTANT NOTE:

If the problem persists, please call our **Consumer Services Department** at **1-800-521-2010** in the U.S., **1-877-352-8697** in Canada, or by going to our website **vtechkids.com** and filling out our **Contact Us** form located under the **Customer Support** link. Creating and developing VTech products is accompanied by a responsibility that we take very seriously. We make every effort to ensure the accuracy of the information, which forms the value of our products. However, errors sometimes can occur. It is important for you to know that we stand behind our products and encourage you to contact us with any problems and/or suggestions you might have. A service representative will be happy to help you.

### Note

This equipment has been tested and found to comply with the limits for a Class B digital device, pursuant to Part 15 of the FCC Rules. These limits are designed to provide reasonable protection against harmful interference in a residential installation. This equipment generates, uses and can radiate radio frequency energy and, if not installed and used in accordance with the instructions, may cause harmful interference to radio communications. However, there is no guarantee that interference will not occur in a particular installation. If this equipment does cause harmful interference to radio or television reception, which can be determined by turning the equipment off and on, the user is encouraged to try to correct the interference by one or more of the following measures:

- Reorient or relocate the receiving antenna.
- Increase the separation between the equipment and receiver.
- Connect the equipment into an outlet on a circuit different from that to which the receiver is connected.
- Consult the dealer or an experienced radio/TV technician for help.

**Caution:** Changes or modifications not expressly approved by the party responsible for compliance could void the user's authority to operate the equipment.

**Supplier's Declaration of Conformity  
47 CFR § 2.1077 Compliance Information**

Trade Name: VTech®  
Model: 5452  
Product name: Fire Rescue Freddie™  
Responsible Party: VTech Electronics North America, L.L.C.  
Address: 1156 W. Shure Drive, Suite 200,  
Arlington Heights, IL 60004  
Website: vtechkids.com

THIS DEVICE COMPLIES WITH PART 15 OF THE FCC RULES. OPERATION IS SUBJECT TO THE FOLLOWING TWO CONDITIONS: (1) THIS DEVICE MAY NOT CAUSE HARMFUL INTERFERENCE, AND (2) THIS DEVICE MUST ACCEPT ANY INTERFERENCE RECEIVED, INCLUDING INTERFERENCE THAT MAY CAUSE UNDESIRE OPERATION.

CAN ICES-003(B)/NMB-003(B)

**Visit our website for more  
information about our products,  
downloads, resources and more.**

***vtechkids.com***  
***vtechkids.ca***

Read our complete warranty policy online at  
***vtechkids.com/warranty***  
***vtechkids.ca/warranty***

